

elevadora_panoramika_69

ESCALA 1:1

2

- Ⓛ Sezione verticale traverso inferiore
- Ⓧ Section verticale traverse inferieure
- Ⓨ Seccion vertical travesaño inferior
- Ⓩ Vertical section lower ledger

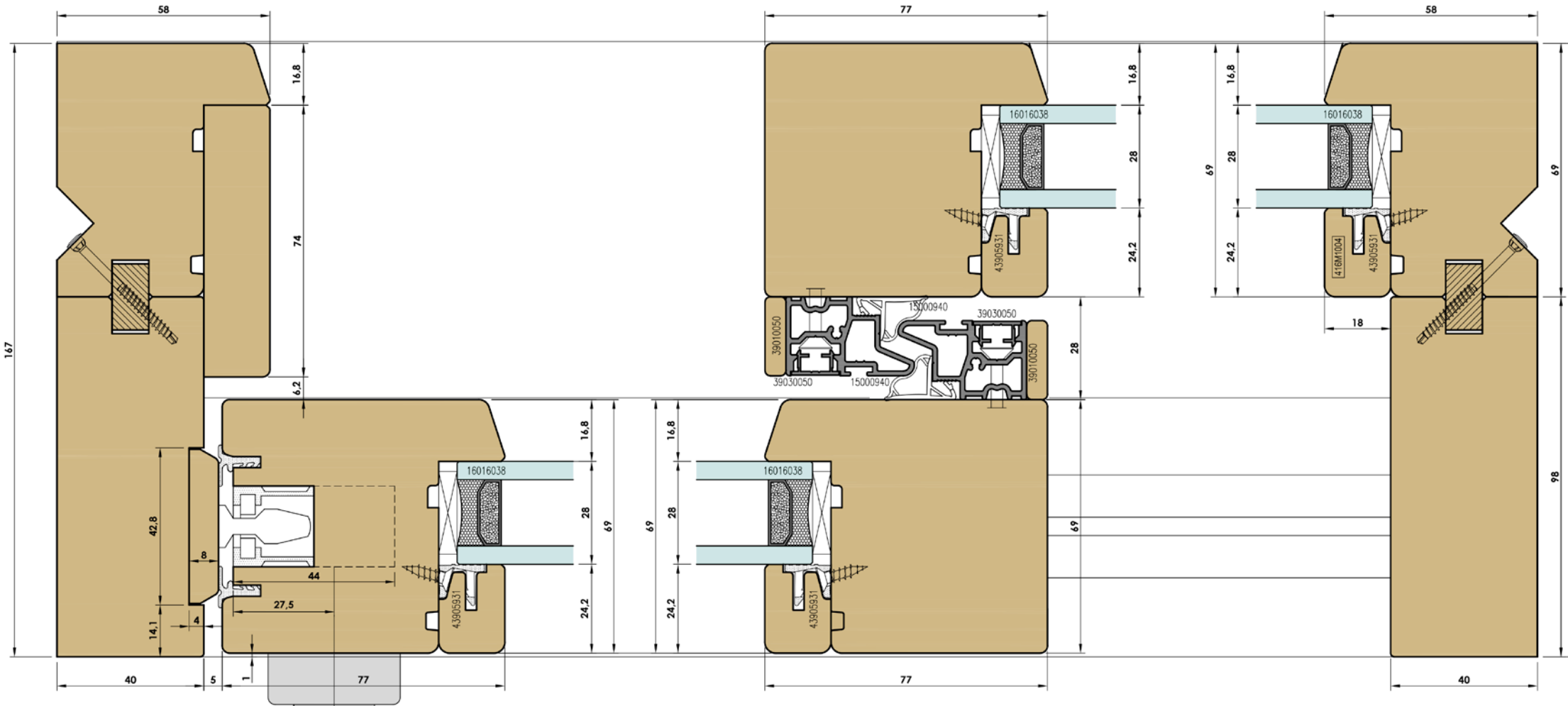

elevadora_panoramika_69

ESCALA 1:1

1

- ⊃ Sezione orizzontale snodo centrale
- ⊄ Section horizontale montant centrale
- ⊅ Seccion horizontal cierre central
- ⊆ Horizontal section of the middle clamp

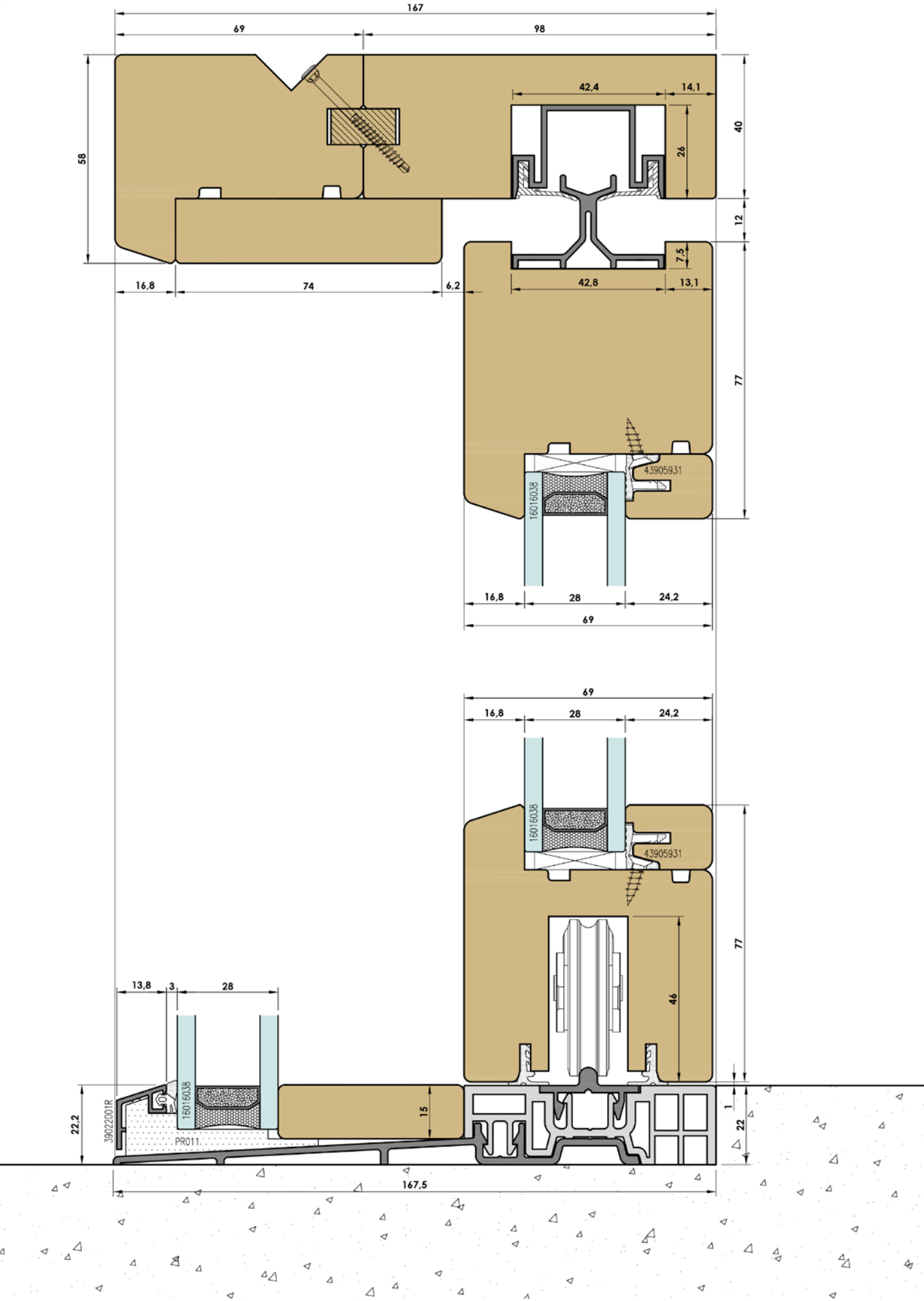

elevadora_panoramika_69

ESCALA 1:1

- Ⓛ Sezione verticale traverso inferiore
- Ⓧ Section verticale traverse inferieure
- Ⓧ Seccion vertical travesaño inferior
- Ⓧ Vertical section lower ledger